

1

Verrière en bouteille soda thermoformée

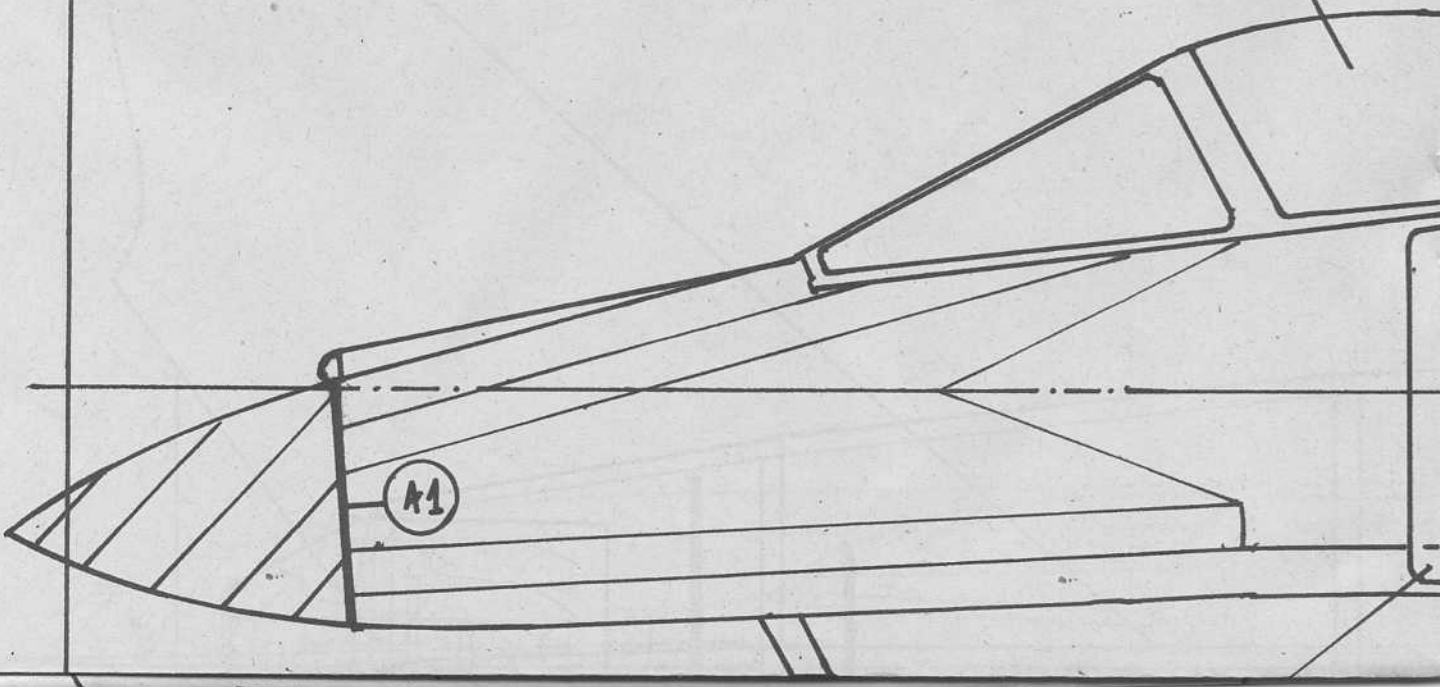

2

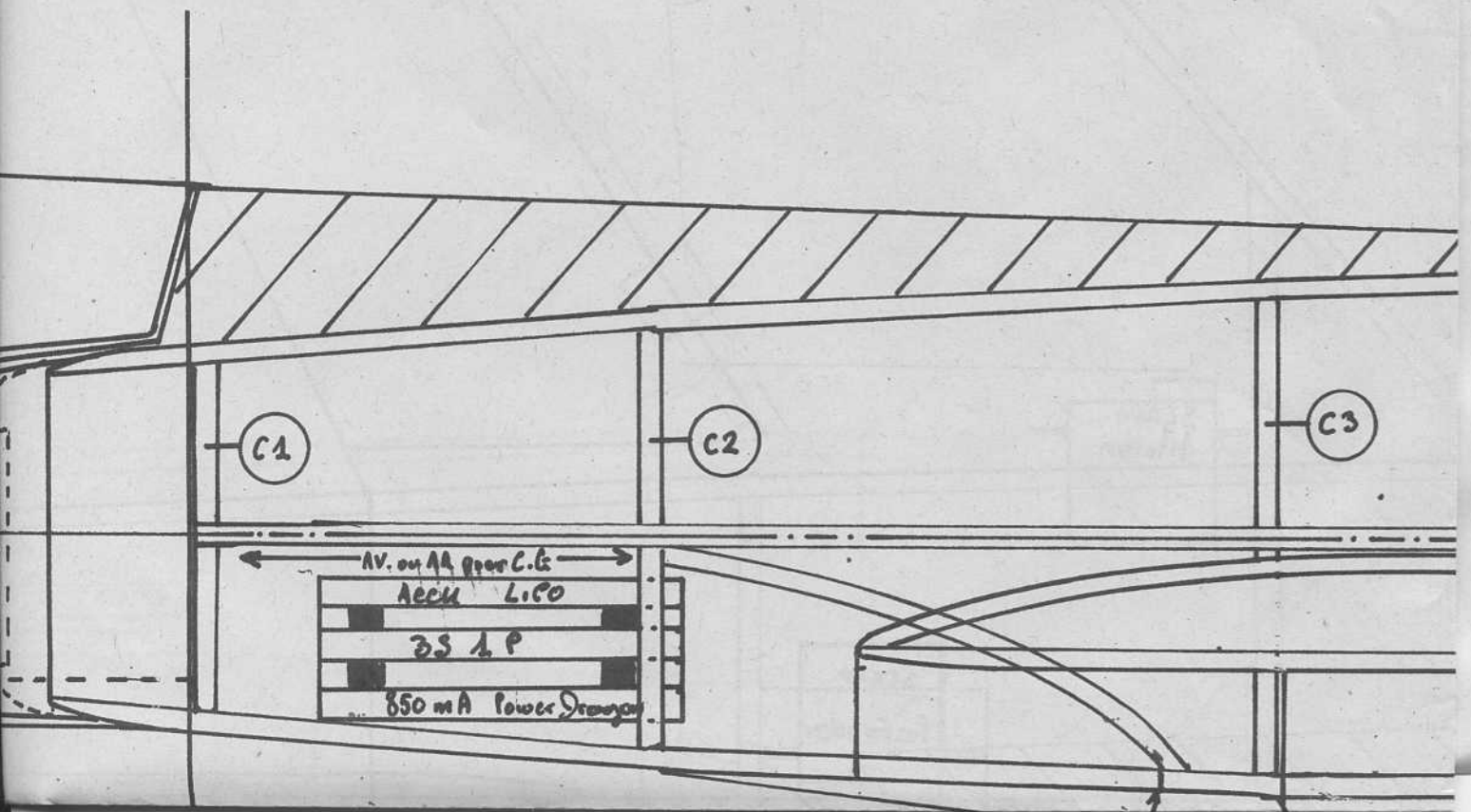

3

Jon e Cur

Renvoi CTP

CTP 8110<sup>e</sup>

boite de renvoi CTP 8110<sup>e</sup>

tube carbone  $\varnothing 3$

C4

RXNPN05 FM

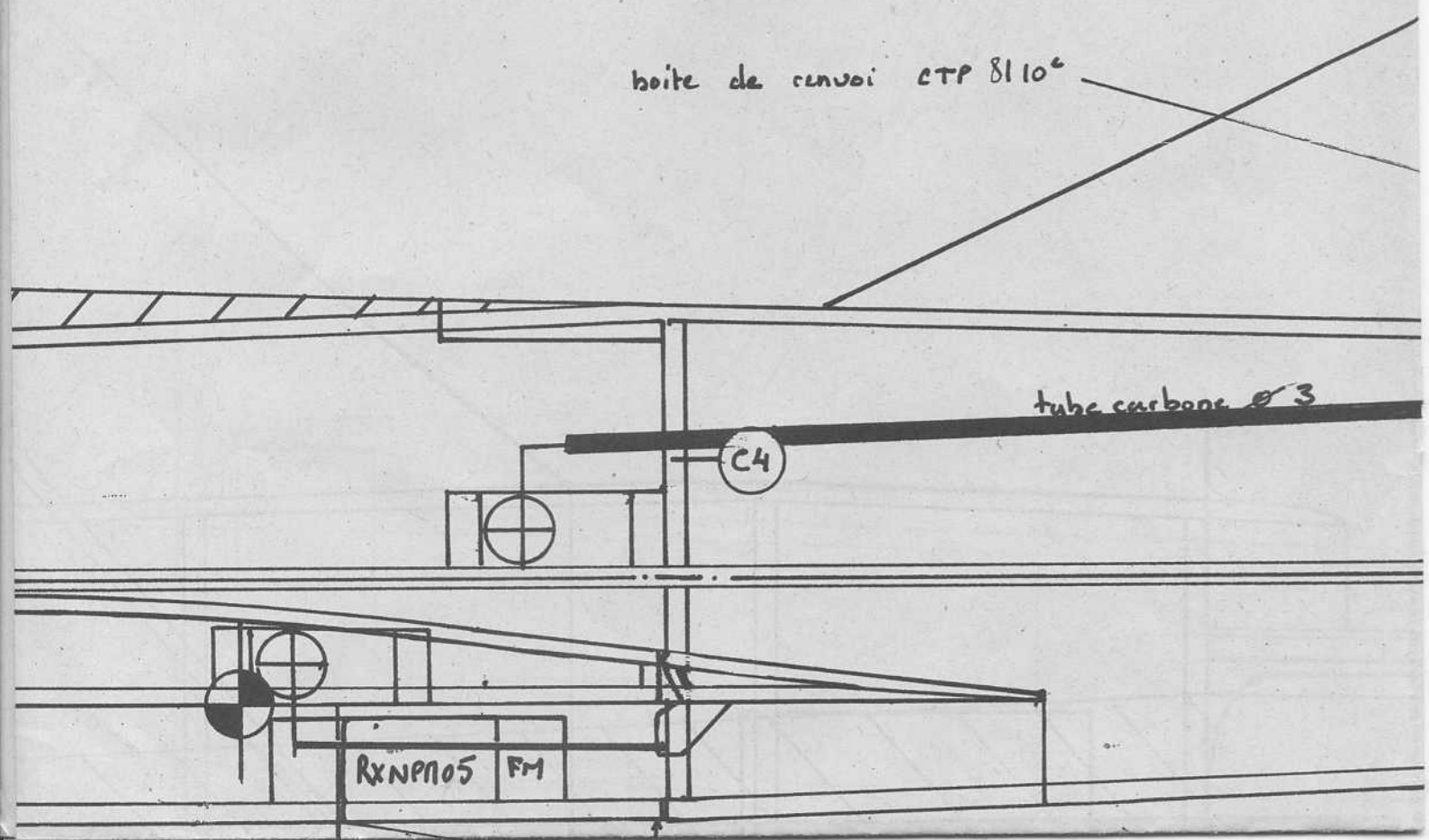

one dans tube alu 3x2

15 110°

DERIVE DEBON 6mm

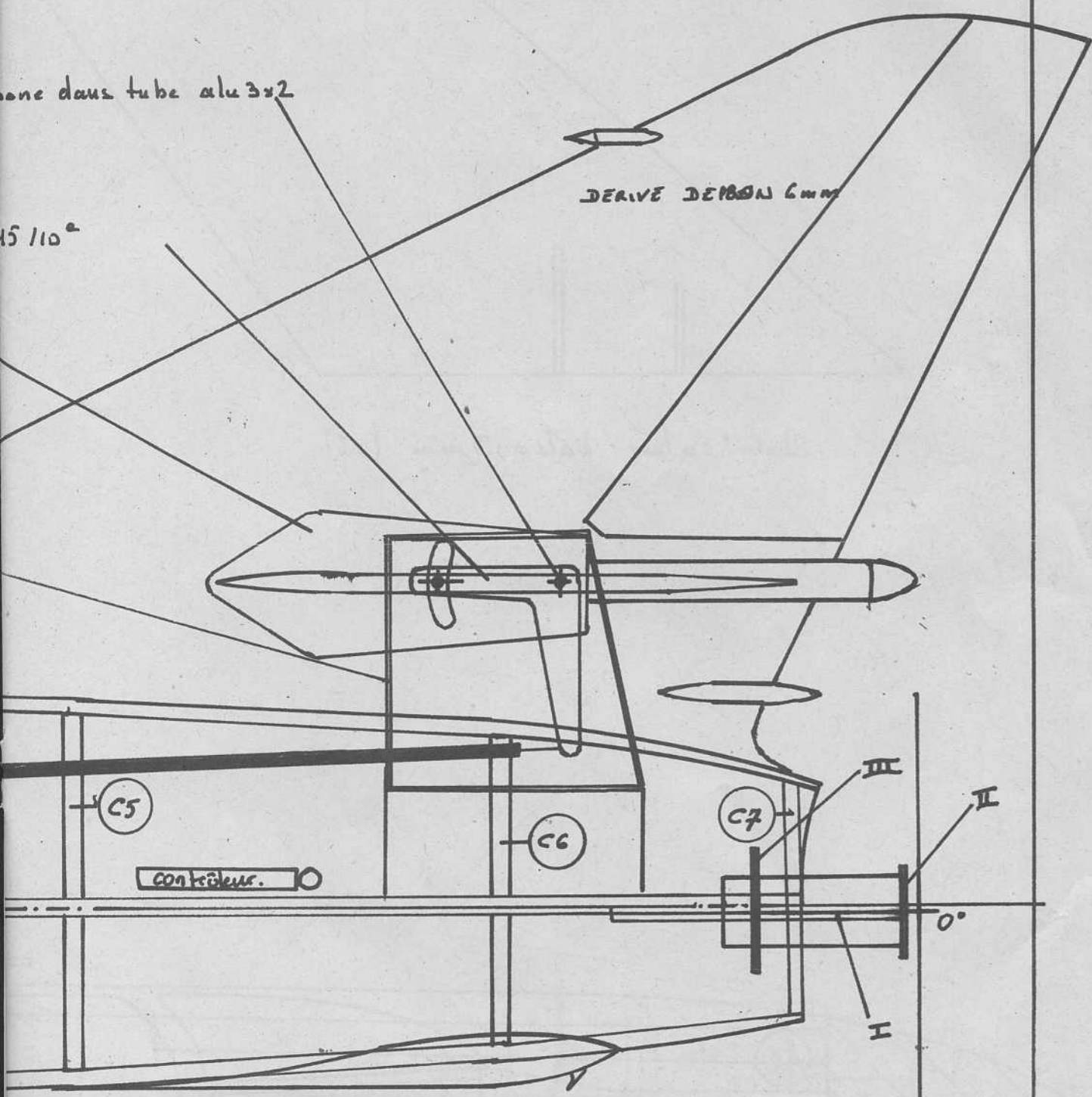



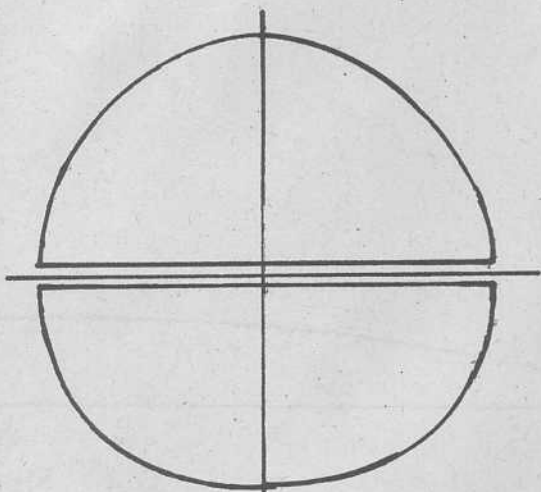

C6  
DEPRON 3mm

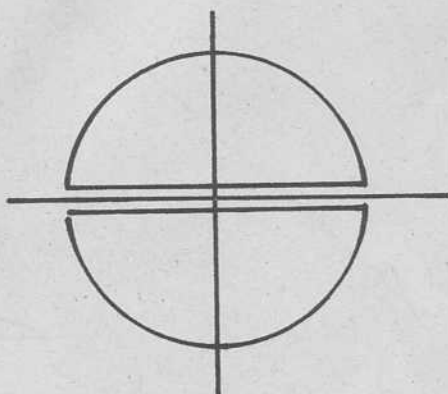

C7  
DEPRON 3mm

## SUPER ETENDARD

Etude, dessin et conception : Philippe Jamet

Plan encarté RCM 306 - octobre 2006

Longueur : 785 mm

Envergure : 570 mm

Surface alaire : 10,1 dm<sup>2</sup>

Masse : 250 grammes

Charge alaire : 24,75 g/dm<sup>2</sup>



de LANCEMENT

truppe radio

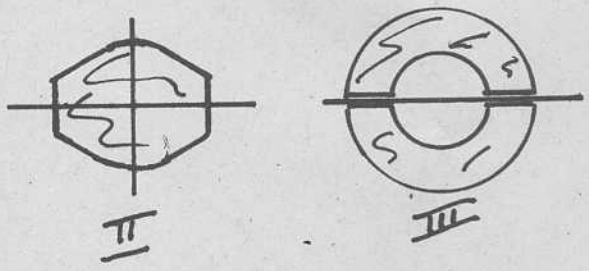
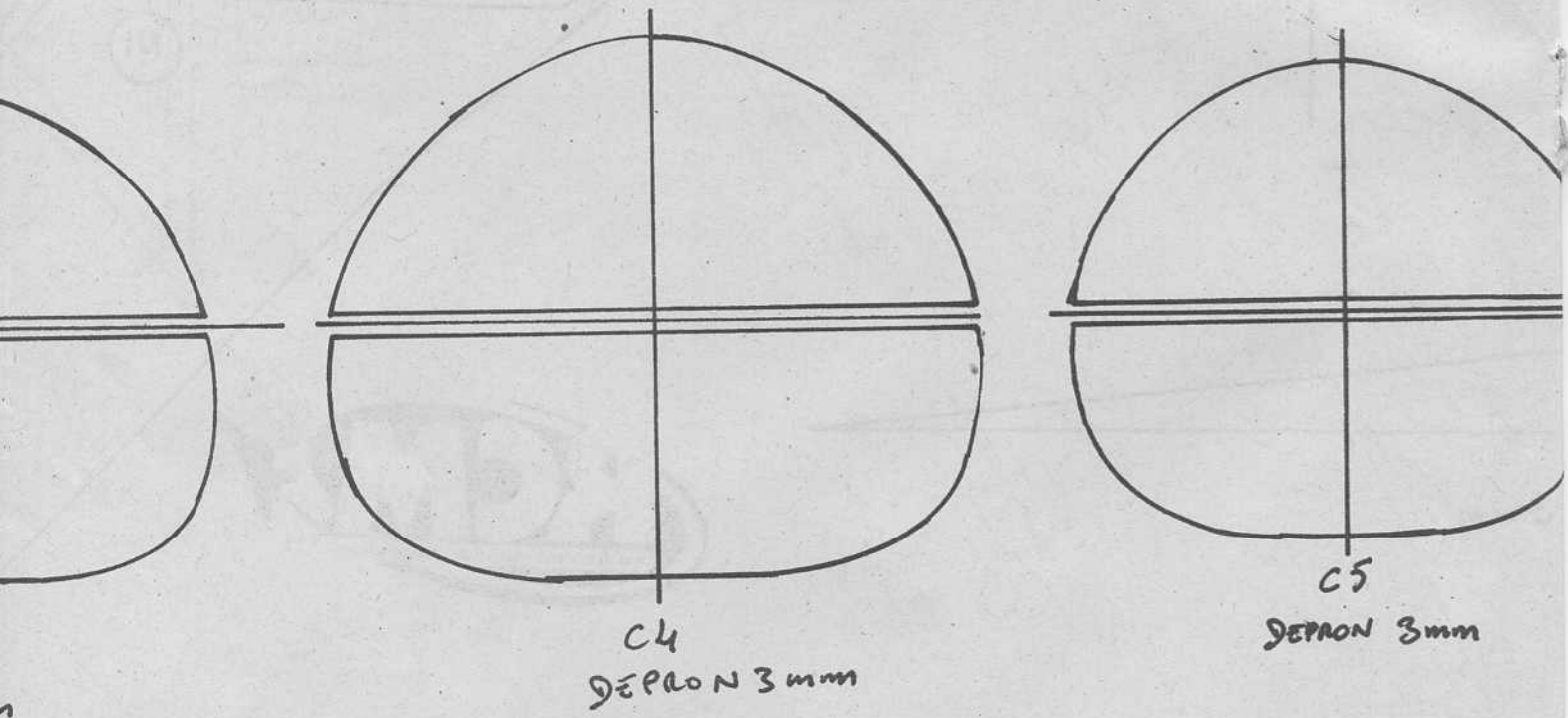

băți motor : I, II, III : CTR 15/10e



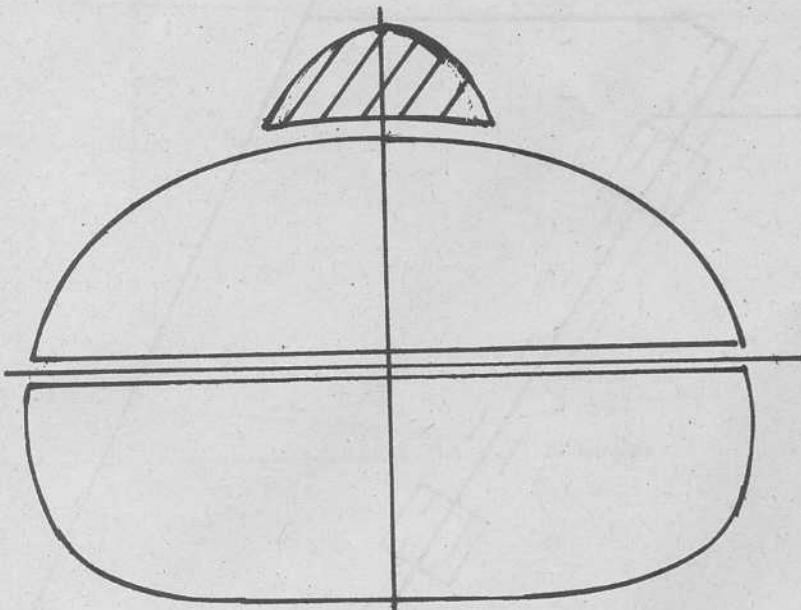

C2  
DEPRON 3mm

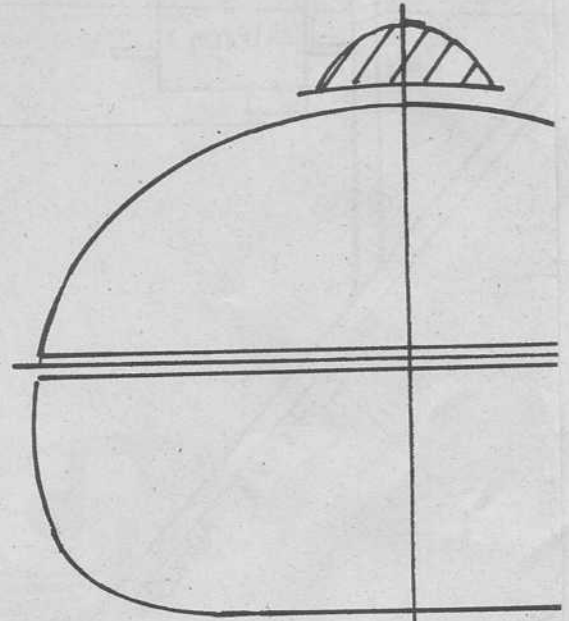

C3  
DEPRON 3mm

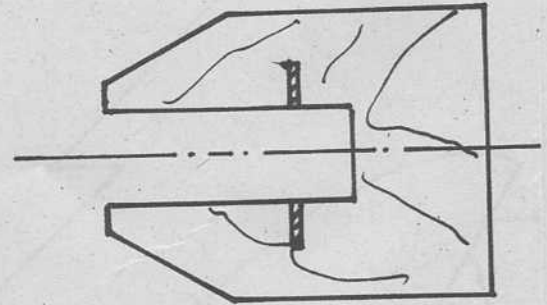

I  
CTP 15/106

CTP 8/10<sup>o</sup>

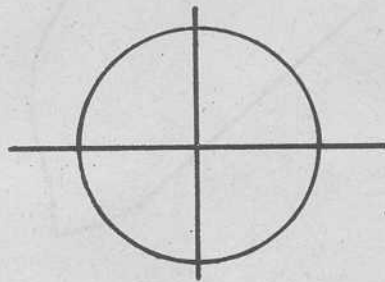

A1  
CTP 8/10<sup>o</sup>

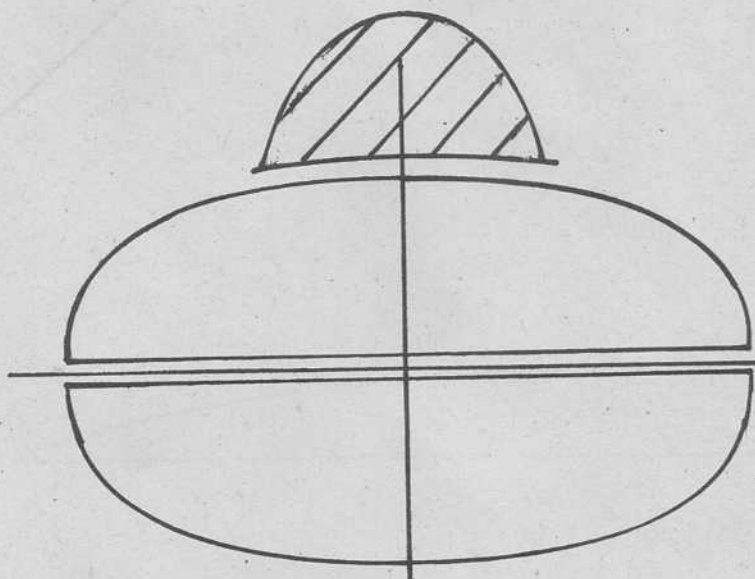

C1  
ГЕРМОН 3mm

8



