

Bord d'attaque : Calca 5x7 -

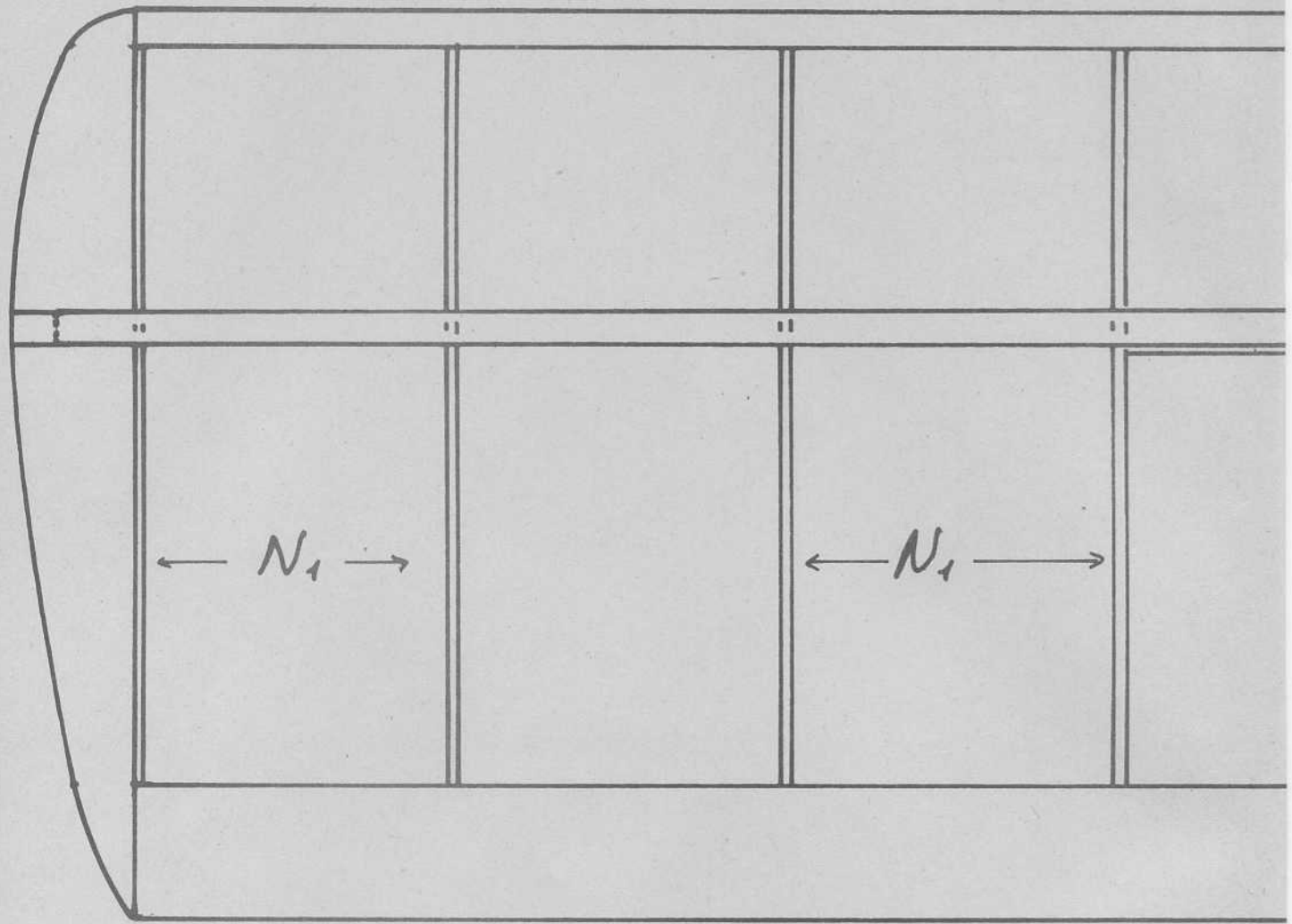

Bord de suite Baguette triangulaire

vue 1

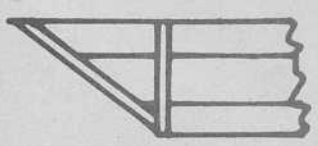

Détail du Surmon
au niveau des
longerons



Détail de
pin 6x6
sur la p

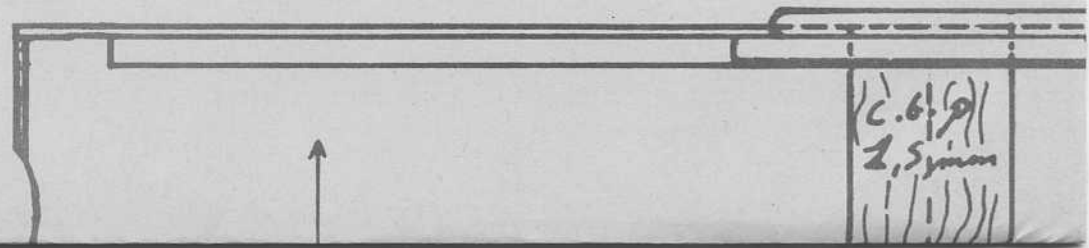

2

B

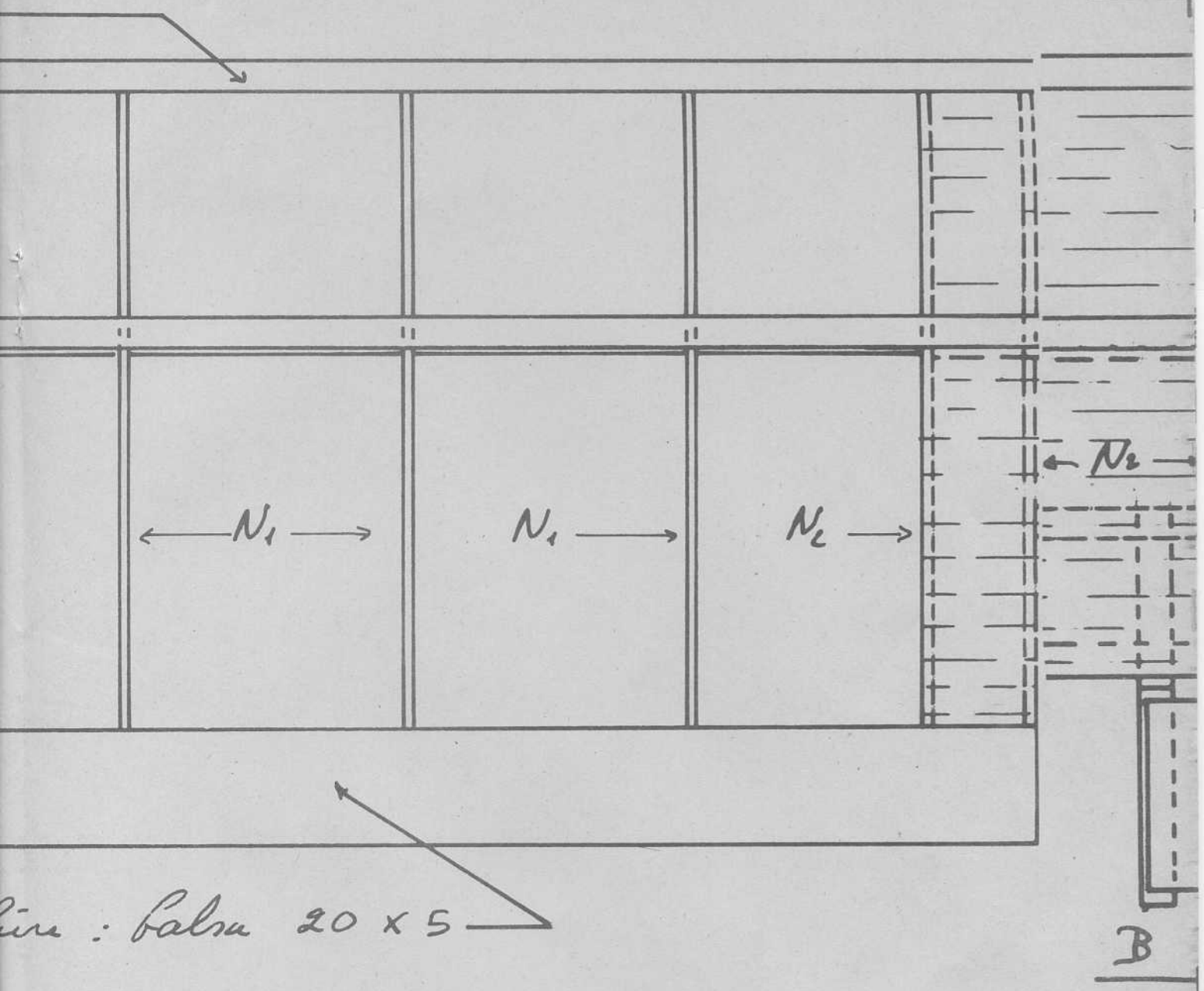

Pine: Balau 20 x 5

Coupe

avant

in mât moteur
bisauté en triangle
partie avant

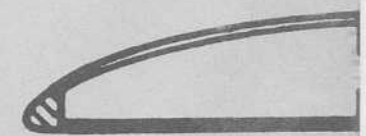

Baguettes de renfort

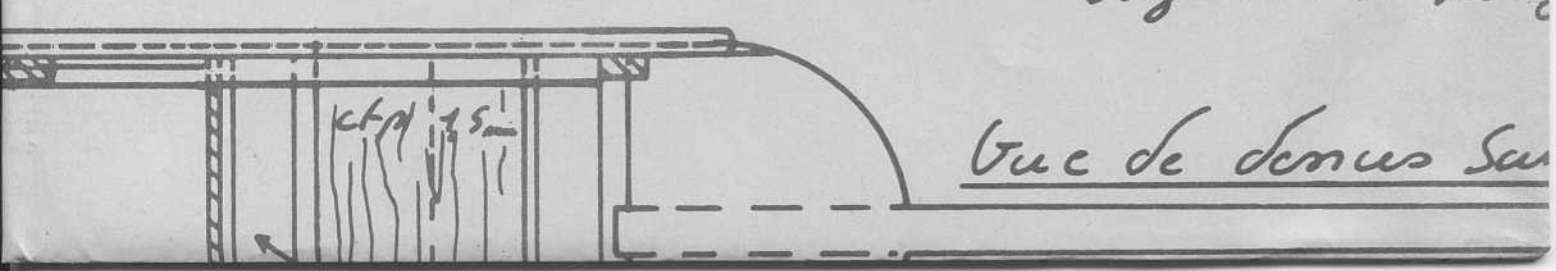

Vue de dessous Sur

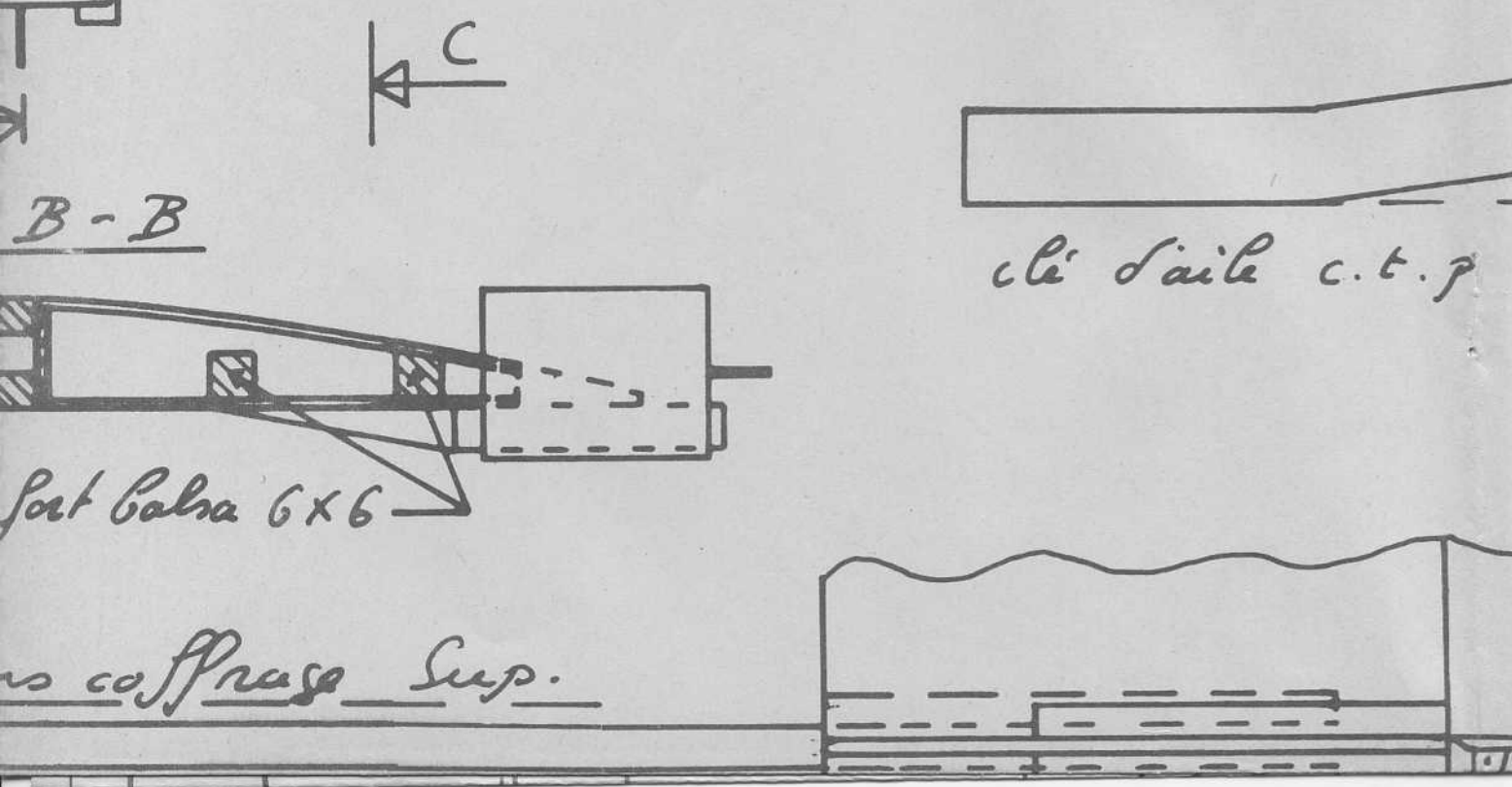
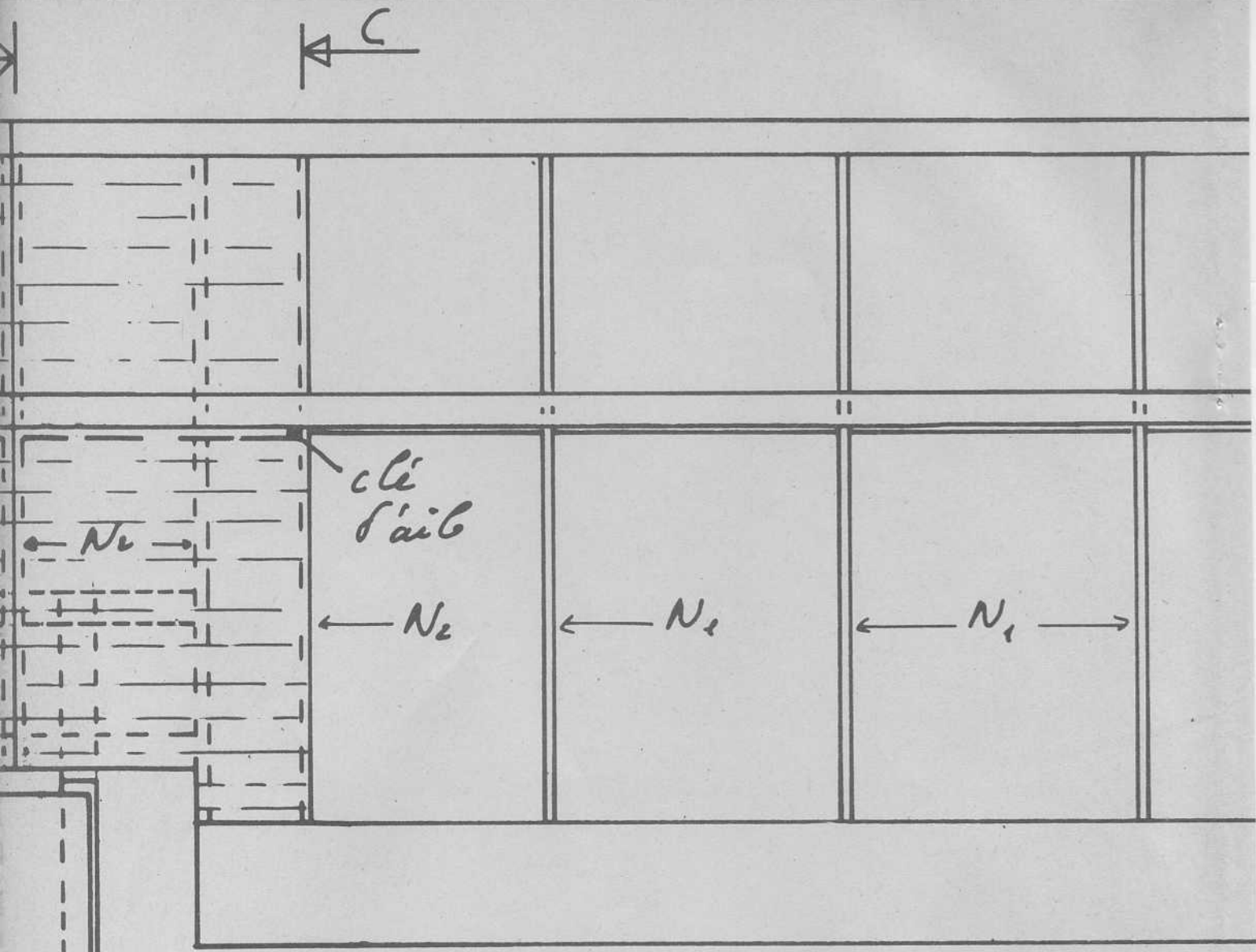

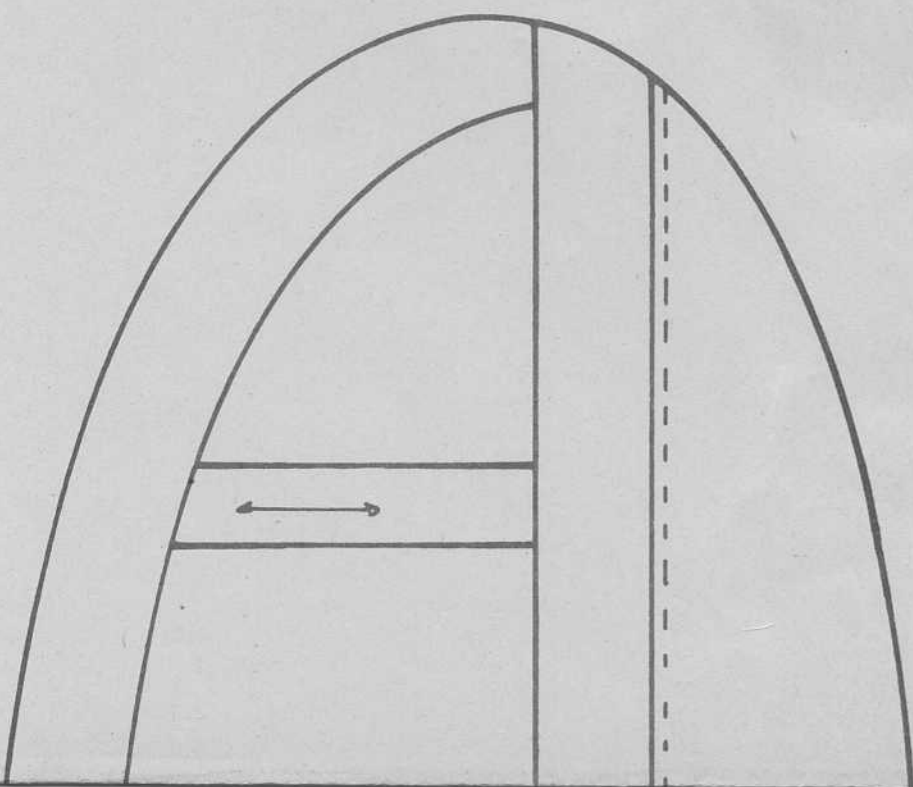
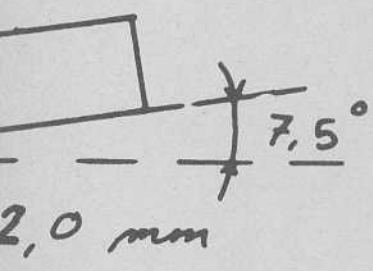
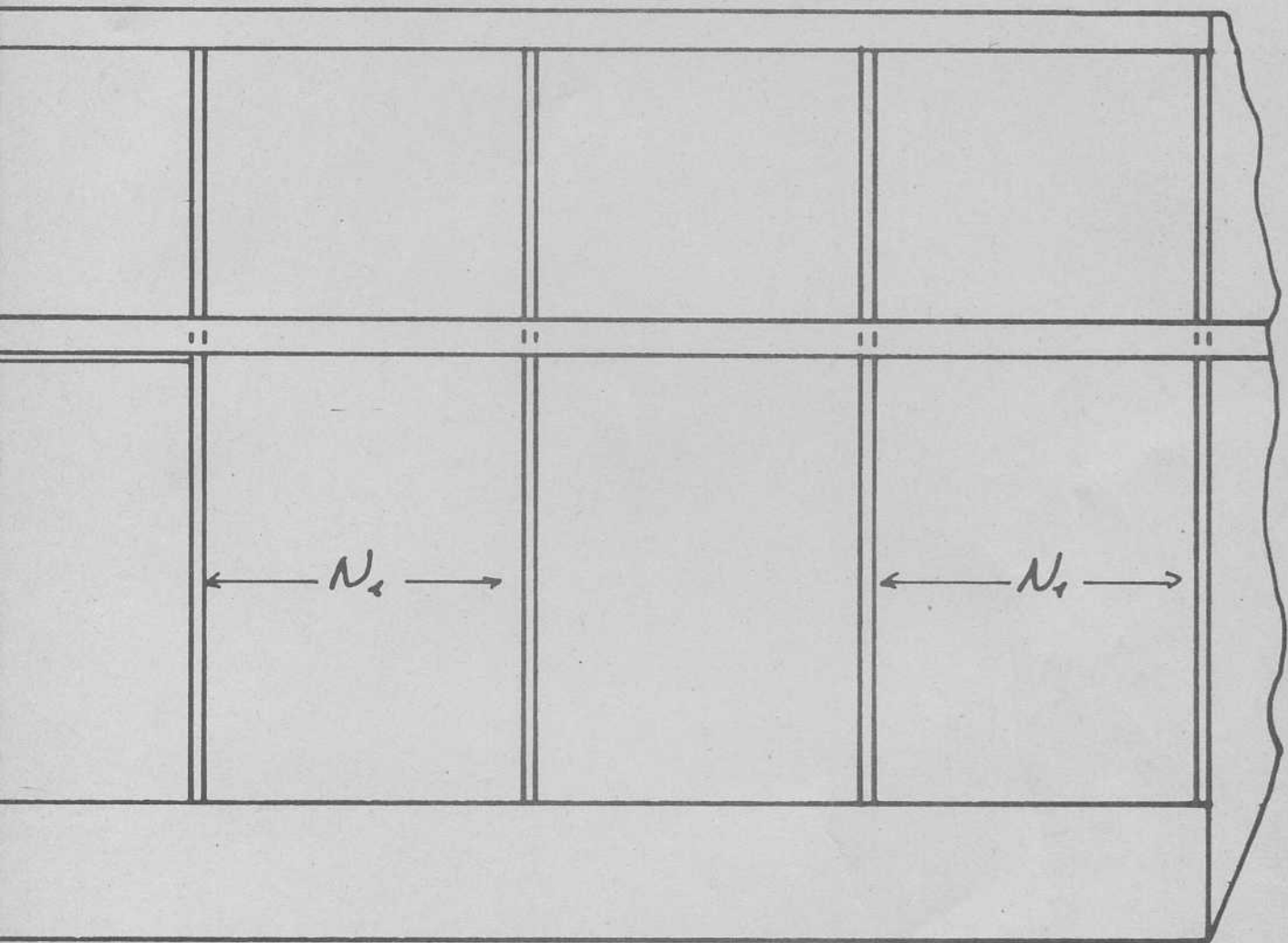

A |

RS
←
irs
lant

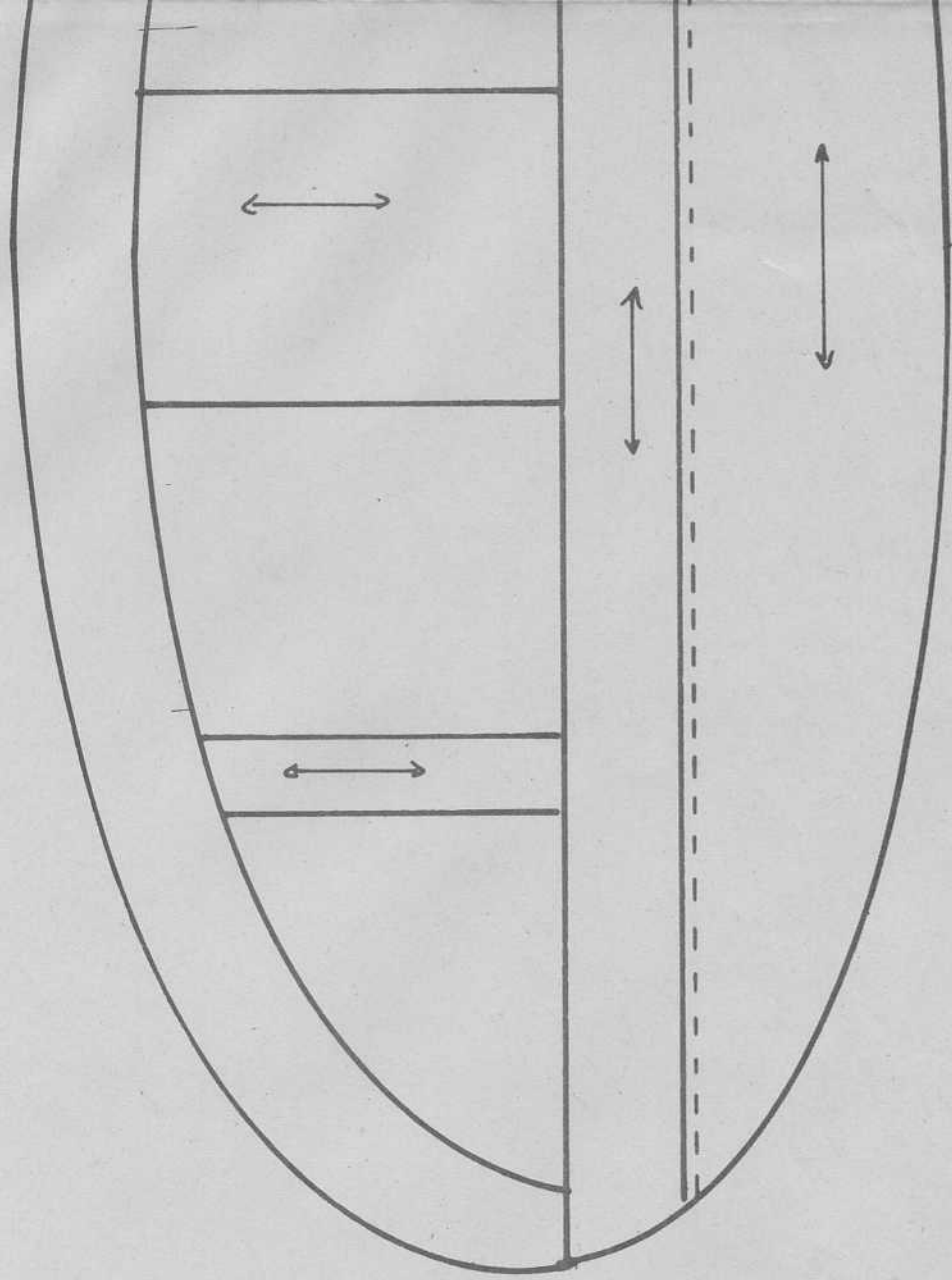

← cap 10mm

Stabilisateur et Servo balsa 2,0 mm Solide

les grandes "maison" plastique ou c.c.p

Volt - air	
------------	--

lien KUITPER Le 20/02/94	planche 1/1
--------------------------	-------------

A aile parasol, moteur propulsif, électrique
--

balsa 2,0 mm



N1

(Sup. Balsa 1,0 mm

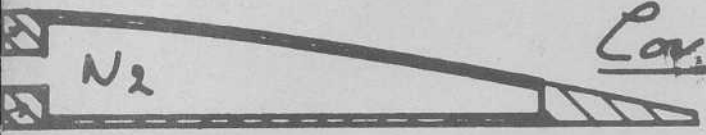

N2

Coupe C-C

Inf. et Sup. Balsa 5x5

5/2

- A

Soutenir le tube de queue

(de flèche) Ø 6 mm

21)

patin ct.p 2,0 mm

gaines de commande
plastique Ø int ≈ 1 mm

AIR LOIS

← Les bois En vente de vos bois chez votre détaillant

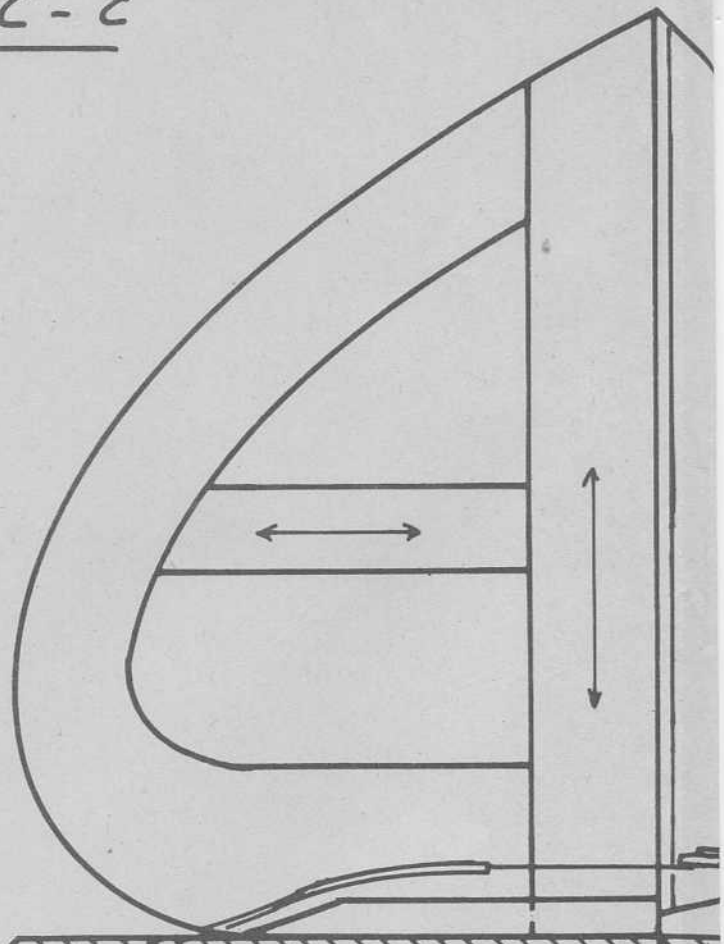

6

1/2

toutes les matières

C.T.P, pin ou bois dur

Nuances :

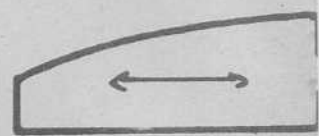

Coffrage inf. et



Conseils c

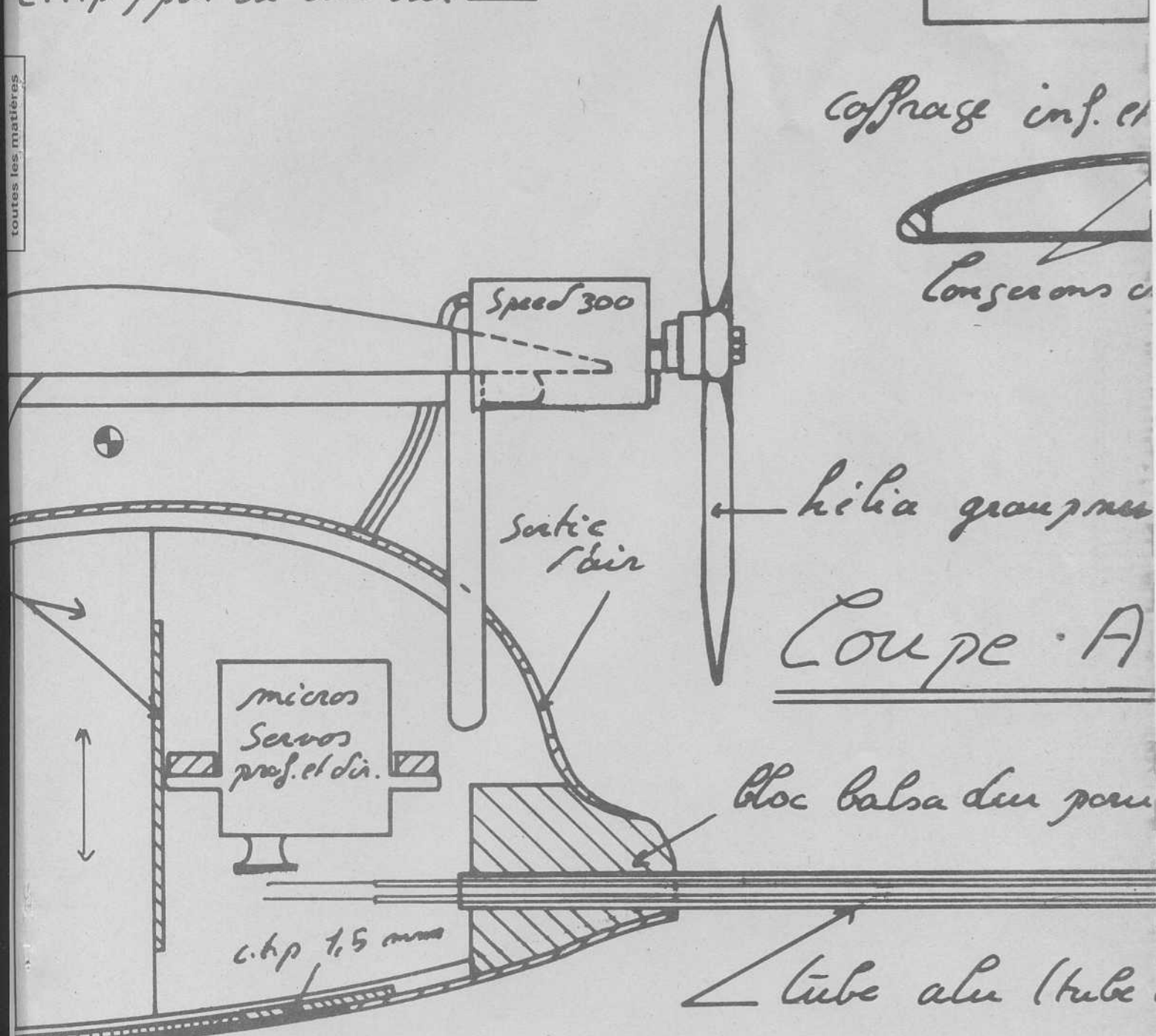

helia groupe me

Coupe A

Bloc balsa dur pour

C.T.P 1,5 mm

tube alu (tube

1,5 mm

trappe coulissante (même principe que sur le gazou looping

1,5 mm

